

Oxford Knit Composite Ltd. (Extension)

260, Ariab, Rupshi, Tarabo Pourosova, Rugganj, Narayanganj

(23.748488, 90.541755)

24 June 2025



1. Building Information

1. Building-5

2. Observation

Observation-1: Mismatches in as-built drawings (Building-5).

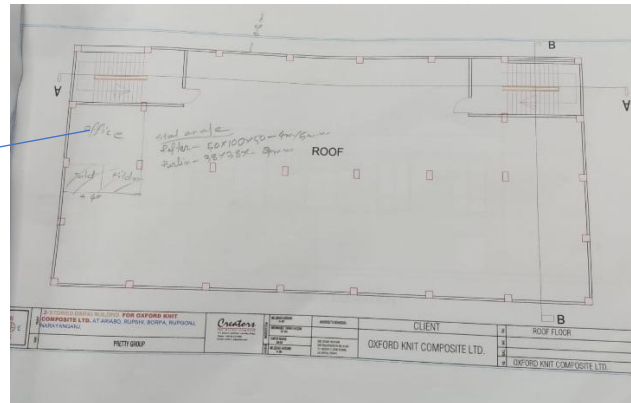

Description: Structural and architectural details were not available for rooftop office shed. The building engineer is required to survey the whole structure and prepare accurate as-built drawings.

Observation 2: Absence of design report (Building-5).



Description: As per BNBC, every building or structure designed shall have its design documents prepared following the provision of Section 1.9.1. The design document shall include a design report and a structural drawing. At the time of inspection, no design report was available which is required to be prepared (including roof shed) in compliance with section 1.9.1.1 and section 1.9.1.2 (part 6, BNBC).

Observation-3: Vehicle impact risk on column (Building-5).



Description: Columns in the south are susceptible to vehicle impact. The factory is required to provide separate column guards to avoid vehicle impact.

Observation 4: Probability of vertical and horizontal extension (Building-5).

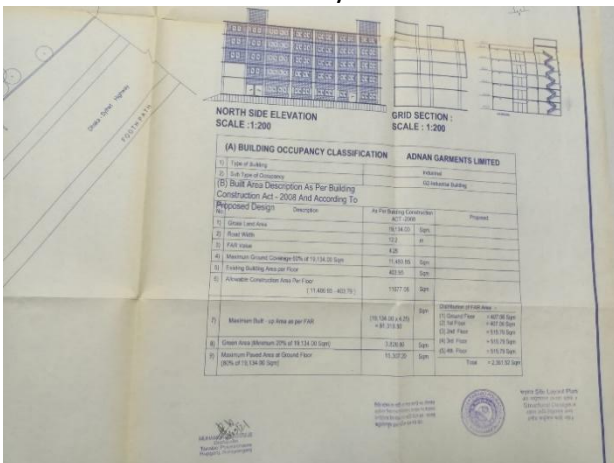

Description: The building is permitted for 5 stories. So, there is a possibility of horizontal & vertical extension of the building according to the approved layout. Prior to any extension, a Detailed Engineering Assessment (DEA) is required to be carried out and submit to RSC for review.

3. Action Plan:

Item No	Observation	Action Plan	Timeline
01	Mismatches in as-built drawings (Building-5).	The building engineer is required to survey the whole structure and prepare accurate as-built drawings for the structure.	within 6 weeks
02	Absence of design report (Building-5).	Prepare design report (including roof shed) for the structure as per 1.9.1 BNBC.	within 6 weeks
03	Absence of design report (Building-5).	Produce an allowable floor load plan for all floors following BNBC requirement.	within 6 weeks
04	Absence of design report (Building-5).	Implement remediation work if required.	within 6 months
05	Absence of design report (Building-5).	Implement floor loading plan (post load plan, mark storage area & height and maintain floor loading within allowable limit).	within 6 months
05	Vehicle impact risk on column (Building-5).	The factory is required to provide separate column guards to avoid vehicle impact.	within 6 weeks
06	Probability of vertical and horizontal extension (Building-5).	In case of any extension, the building engineer is required to conduct a Detail Engineering Assessment (DEA) prior commencement of construction work. Submit DEA documents to the RSC for review.	within 6 months