

York Composite Ltd.

Plot# 08,09,10 BSCIC Industrial Estate, Kanchpur, Sonargaon, Narayanganj
(23.697660, 90.527756)

2 July 2024



1. Building Information

1. Partially 7-storied Main Building
2. 2-storied Utility Building
3. 2-storied ETP Building
4. Single Storied, Shed 1: Boiler Shed
5. Single Storied, Shed 2: Yarn Store Shed
6. Single Storied, Shed 3: Child Care Room
7. Single Storied, Shed 4: RMS Shed
8. Single Storied, Shed 5: Security Shed

2. Observation:

Observation-02: Foundation and column stressed above normal design limit for further construction. (Main Building)

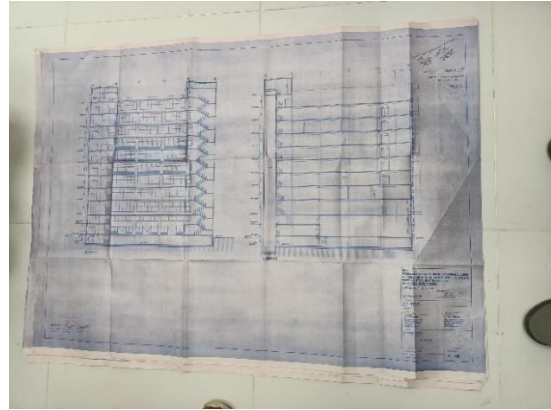

Description: Few columns and foundations are found to be stressed above normal design limit considering minimum concrete strength and 10-storied RC building. The building engineer is required to carry out Detailed Engineering Assessment (DEA) before conducting any extension work.

Observation-02: Hairline cracks on facade walls. (Main Building)



Description: Crack was found on brick wall at top floor. The building engineer is required to investigate the cracked area and repair with a suitable method.

Observation-03: Nonstructural elements found not anchored/braced. (Main Building)



Description: Plastic water tanks and storage rack were found not anchored/braced. The building engineer is required to anchor/brace all nonstructural elements to avoid falling hazards during earthquake.

Observation-04: Trolley impact on RC pedestal columns. (Main Building)



Description: Trolley impact was observed on RC pedestal columns. The building engineer is required to repair the damaged plaster and provide protection to prevent trolley impact on RC pedestal columns.

Observation-05: Construction materials, temporary bamboo frame and water clogging on the roof. (Main Building)



Description: Construction materials and bamboo frames were found almost everywhere on the roof. Building engineer is required to remove all kind of construction materials and bamboo frame from the roof. Also, provide adequate drainage to avoid water clogging on roof.

Observation-06: Undocumented single-storied masonry shed adjacent to Main building at South. (Main Building)



Description: An undocumented single-storied shed was found at the south side of the building. The roof frame is connected with the façade of Main Building on GF. Building engineer is required to separate the roof structure from Main Building and provide adequate support & connection for roof frame. Also, prepare as-built drawings.

Observation-07: Adequacy of external steel stair for vertical and lateral loading. (Main Building and Utility Building)



Description: Lateral load-resisting system was not found in the external steel stair. Also, vertical members are found to be inadequate. Building engineer is required to check the adequacy of the external steel stair for vertical and lateral loading.

Observation-08: Lack of design report. (Utility Building)



Description: As per BNBC, every building or structure designed shall have its design documents prepared in accordance with the provision of Section 1.9.1. During inspection, the design report was not available on site.

The building engineer is required to prepare a set of design documents including as-built drawings, live load plan, and software-based analysis which shall be prepared in compliance with section 1.9.1, part-6 of BNBC.

Observation-09: Significant vibration on 1st floor. (Utility Building)



Description: Significant vibration was felt on the first floor due to operation of heavy machineries. Building engineer is required to investigate the long-term effect of the vibration and suggest remediation.

Observation-10: Improper connection and inadequate truss member on GF. (ETP Building)



Description: Improper connection and inadequate truss members were found on the ground floor extension roof shed of ETP building. Trusses are resting on the grill with poor welding. The building engineer is required to proposed remediation design of the inadequate members, connections and structural system.

Observation 11: Lack of as-built drawing (Shed-1, 2, 3, 4 & 5).



Description: As-built drawings were not available for the ancillary structures. The building engineer is required to prepare as-built drawings for all the structures.

Observation-12: Lack of lateral stability. (Shed-2)



Description: Lateral load transfer media was found missing in the perpendicular direction of the truss frame. Also, one truss frame was found discontinue to the column. Also, truss bottom member was found discontinue at middle. Building engineer is required to check the connection adequacy and lateral stability of the structure. Also, repair the bottom member of the truss with same materials.

Observation 16: Improper connection, inadequate roof framing members and support. (Shed-1, 3, 4 & 5).

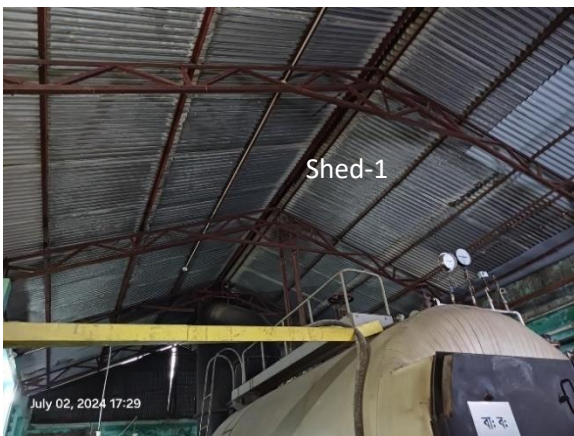

Description: Inadequate roof framing members and vertical support members were found in these sheds. Also, the connection between the truss/rafter and columns was found improper. The building engineer is required to proposed remediation design of the inadequate members and connections.

3. Action Plan:

Item No.	Observation	Action Plan	Timeline
1.	Foundation and column stressed above normal design limit for further construction. (Main Building)	The building engineer is required to carry out Detail Engineering Assessment (DEA) before conducting any extension work.	within 6 weeks
2.		Verify in situ concrete strength (100mm dia. cores from 4 columns) from the lower tier of the building.	within 6 weeks
3.		Carry out the suggested remedial work if required.	within 6 months
4.		Implement floor loading plan.	within 6 months
5.	Hairline cracks on facade walls. (Main Building)	The building engineer is required to investigate the cracked area and repair with a suitable method	within 6 weeks
6.	Non-structural elements found not anchored/braced. (Main Building)	The building engineer is required to anchor/brace all non-structural elements to avoid falling hazards during earthquakes.	within 6 weeks
7.	Trolley impact on RC pedestal columns. (Main Building)	The building engineer is required to repair the damaged plaster and provide protection to prevent trolley impact on RC pedestal columns.	within 6 weeks
8.	Construction materials, temporary bamboo frame and water clogging on the roof. (Main Building)	Building engineer is required to remove all kind of construction materials and the bamboo frame from the roof and keep the roof clean.	within 6 weeks
9.		Provide adequate discharge and drainage to avoid water clogging on roof.	within 6 months
10.	Undocumented single-storied masonry shed adjacent to Main building at South. (Main Building)	Building engineer is required to separate the roof structure from Main Building and provide adequate support & connection for roof frame.	within 6 weeks
11.		Prepare full set of as-built drawings.	within 6 weeks
12.	Adequacy of external steel stair for vertical and lateral loading. (Main Building and Utility Building)	Building engineer is required to check the adequacy of the external steel stair for vertical and lateral loading. Also, suggest suitable repair method.	within 6 weeks
13.		Carry out the suggested remedial work.	within 6 months

Item No.	Observation	Action Plan	Timeline
14.	Lack of design report. (Utility Building)	The building engineer is required to prepare a set of design documents including as built drawings, live load plan and software-based analysis which shall be prepared in compliance with section 1.9.1, part-6 of BNBC.	within 6 weeks
15.		Carry out the suggested remedial work if required.	within 6 months
16.		Implement floor loading plan.	within 6 months
17.	Significant vibration on 1 st floor. (Utility Building)	Building engineer is required to investigate the long-term effect of the vibration and suggest remediation.	within 6 weeks
18.	Improper connection and inadequate truss member on GF. (ETP Building)	The building engineer is required to proposed remediation design of the inadequate members, connections and structural system.	within 6 weeks
19.		Carry out the suggested remedial work where required.	within 6 months
20.	Lack of as-built drawing. (Shed-1, 2, 3, 4 & 5)	The building engineer is required to prepare as-built drawings for all the structures.	within 6 weeks
21.	Lack of lateral stability. (Shed-2)	Repair the discontinued bottom member of the truss with same materials.	within 6 weeks
22.		Building engineer is required to check the connection adequacy and lateral stability of the structure.	within 6 weeks
23.		Carry out the suggested remedial work where required.	within 6 months
24.	Improper connection, inadequate roof framing members and support. (Shed-1, 3, 4 & 5).	The building engineer is required to proposed remediation design of the inadequate members and connections.	within 6 weeks
25.		Carry out the suggested remedial work where required.	within 6 months