



Renaissance Barind Ltd

Plot 63 to 68 & 72 to 77, Ishwardi EPZ, Pakshey, Ishwardi, Pabna, Bangladesh.

(24.095712N, 89.032602E)

22nd August 2019





Observations



Implement the floor load management program



Load management program was not implemented. Factory is required to implement the floor load management program by providing signage, load restriction height marking on storage area, record keeping of the load. In the gardening area earth height not to exceed the existing height.



Water proofing works on roof



Water ponding was found at roof level.



Ongoing water proofing work

Building engineer is required to improve the roof drainage system and complete the ongoing water proofing works.



Additional earth load of roof garden

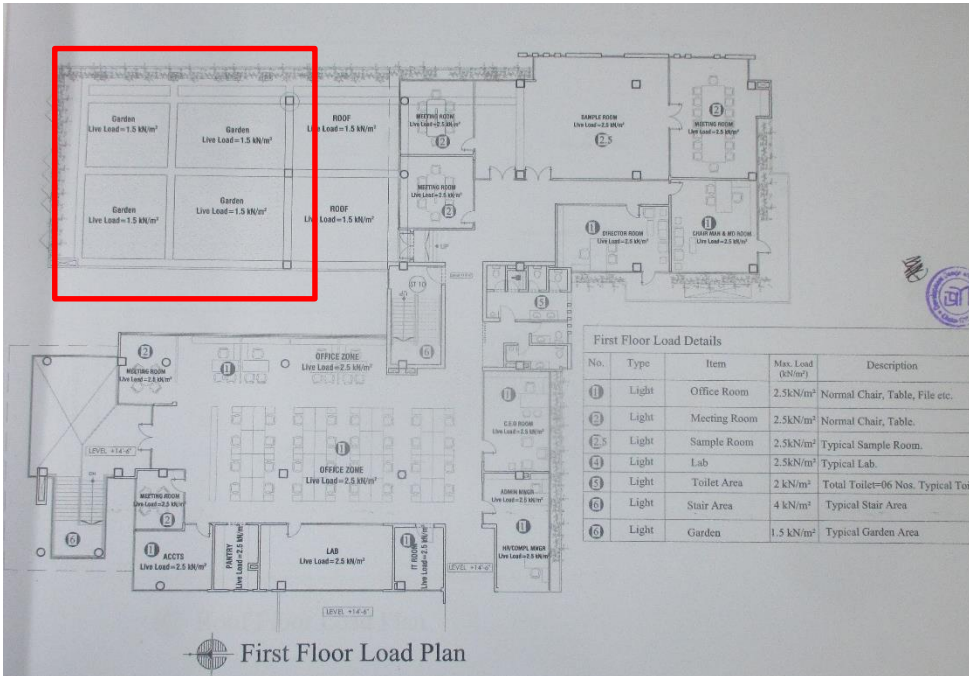

5.7 kPa load observed on roof for the 300 mm earth load.

1.5 kPa Live load considered on the roof slab

Additional earth load was observed on the roof slab. Building engineer is required to check the slab adequacy for the additional load.



Water proofing works on roof



Water ponding was found at roof level.



Ongoing water proofing work

Building engineer is required to improve the roof drainage system and complete the ongoing water proofing works.



Problems Observed

Production Building:

01: Implement the floor load management program.

02: Water proofing works on roof.

Office Building :

03: Additional earth load of roof garden.

04: Water proofing works on roof.



Item No.	Observation	Recommended Action Plan	Recommended Timeline
1	Implement the floor load management program.(Production Building)	Implement the floor load management program by providing proper signages and load restriction height marking.	6-weeks
2	Water proofing works on roof.(Production Building)	Building engineer is required to improve the roof drainage system and complete the ongoing water proofing works.	6-weeks
3	Additional earth load of roof garden.(Office Building)	Building engineer is required to check the slab adequacy for the additional load or limit the loading within the produced load plan.	6-weeks
4	Additional earth load of roof garden.(Office Building)	Carry out any remedial works where required.	6-months
5	Water proofing works on roof.(Office Building)	Building engineer is required to improve the roof drainage system and complete the ongoing water proofing works.	6-weeks