



Pacific Casuals Ltd.

Plot: 31-32, Sector: 1, CEPZ, Chattogram
(22.292645, 91.774568)
05th August 2019





Observations



Columns susceptible to impact loading



Columns at loading bay are susceptible to impact loading from vehicles.



Ground floor column in loading-unloading bay



Corrosion found on steel member of supporting Structure



Excessive corrosion was found in steel member of supporting structure at East. The building engineer to investigate the reason & extent of corrosion and suggest proper remedial measure accordingly.

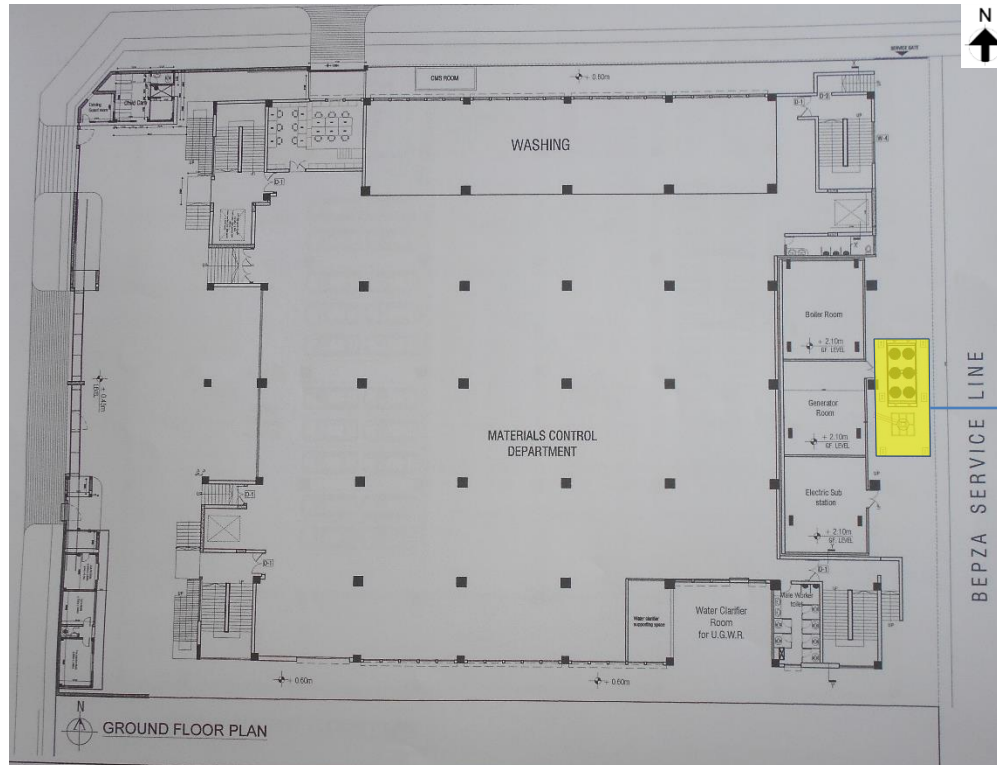

Ground Floor Layout



Corrosion at column



Corrosion at I-Joist & bracing



Problems Observed

Production Building:

- 1: Columns susceptible to impact loading.
- 2: Corrosion found on steel member of supporting Structure.



Priority Actions



Item No.	Observation	Recommended Action Plan	Recommended Timeline
1	Columns susceptible to impact loading.	Construct and maintain protection to critical column and continue to assess likelihood of vehicle impact to critical elements.	6-weeks
2	Corrosion found on steel member of supporting Structure	The building engineer to investigate the reason & extent of corrosion and suggest proper remedial measure accordingly.	6-weeks
3	Corrosion found on steel member of supporting Structure	Take necessary measures to prevent further corrosion and repair the corroded steel members as per engineer's suggestion.	6-months