

Marma Composite Ltd. (extension)

Tongabari, Ashulia, Savar , Dhaka

(23.900852, 90.318806)

7th January 2019





Observations



Column to be stressed above normal design limits for the full height over head water tank

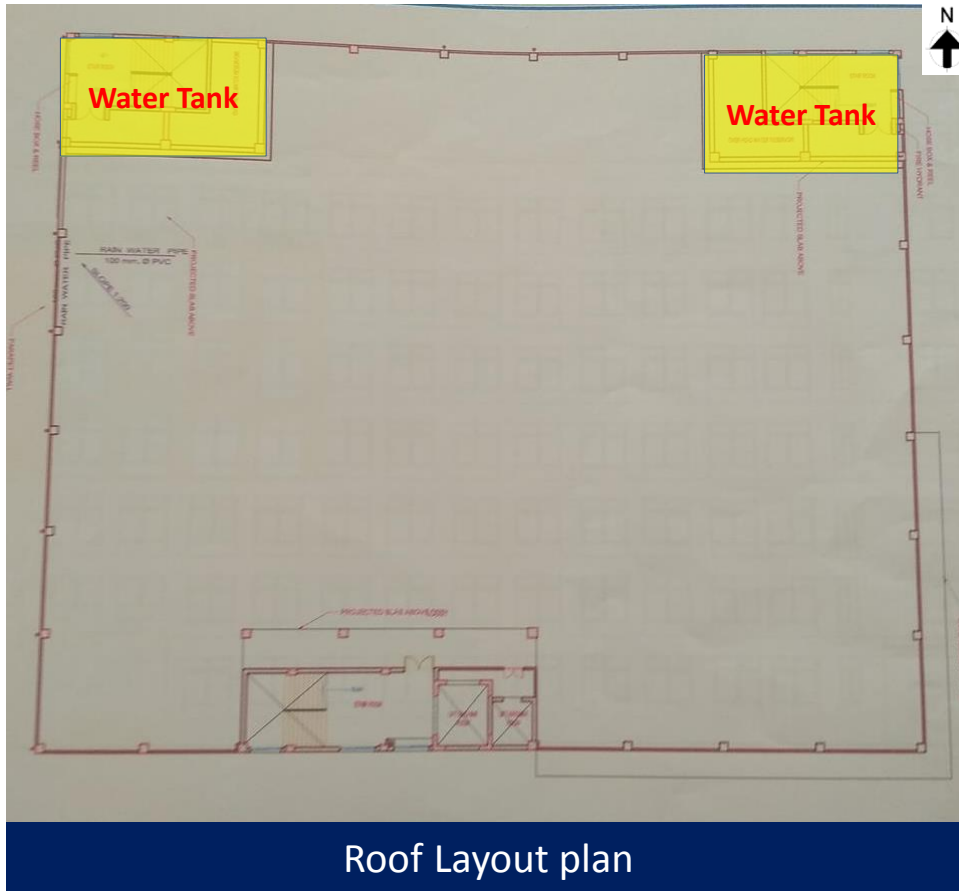

Roof Layout plan

Roof slab of the Garments building was under construction and FoS calculation for column was found satisfactory without over head water tanks.



Under construction roof

As per proposed drawing, Two over head water tanks will be constructed at North-East & North-west corner. Column to be stressed above normal design limits if considered full height of water tanks. Factory engineer is required to review the design before constructing the full height water tanks.



Problems Observed

Garments Building:

01: Column to be stressed above normal design limits for the full height over head water tank.



Item No.	Observation	Recommended Action Plan	Recommended Timeline
1	Column to be stressed above normal design limits for the full height over head water tank	Factory Engineer to review design, loads and columns stresses for full construction.	6-weeks
2	Column to be stressed above normal design limits for the full height over head water tank	Produce and actively manage a loading plan for all floor plates within the factory giving consideration to floor capacity and column capacity.	6-weeks
3	Column to be stressed above normal design limits for the full height over head water tank	Make any structural alterations as advised by Building Engineer.	6-months
4	Column to be stressed above normal design limits for the full height over head water tank	Continue to implement loading plan.	6-months