

# Vintage Garments Ltd. (9637)

Eat Narshingpur, Buri Para, Ashulia, Savar

(+23.933662N, +90.310448E)

30.April.2014



ACCORD  
on Fire and Building Safety in Bangladesh



## Identified Priority 3 Concerns

- Main building – Structural system does not match construction documentation'
- Steel shed at roof and ground floor.
  - No Waterproofing at roof.

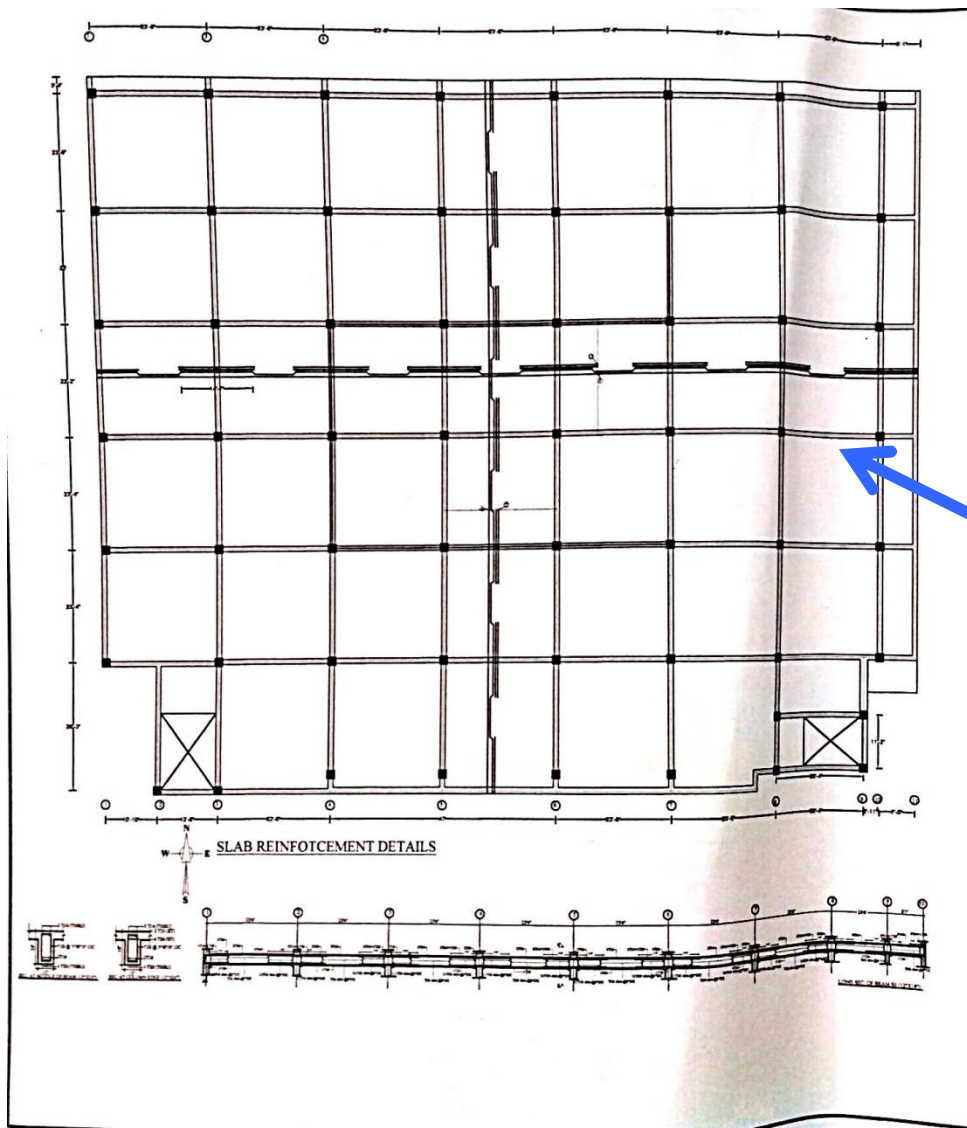

1<sup>st</sup> Priority 3 concern

As mentioned previously, the construction documents do match the actual site conditions

There are no downstand beams in this building



2<sup>nd</sup> Priority 3 concern

We require an Engineering Assessment of the steel sheds at the ground floor and the roof. Unrestrained flanges for purlins. Unrestrained condition for uplift forces on the main trusses.





### 3<sup>rd</sup> Priority 3 concern

No waterproofing membrane was visible on the roof of the building. This means that any cracks in the surface finishes on the roof will allow water to seep into the concrete slab beneath the finishes, and cause long-term soaking of the slab. The same applies for water tanks at roof level.

# Overall Stability System



Sway stability of the building could probably be expected from a rigid frame system (slab and column participation) although no ductile detailing is provided in structural plans.

Masonry infill is unrestrained and cannot be considered as helpful.

We require that these items be investigated in an Engineering Assessment

# Priority Actions

## Problems Observed Summary

**ITEM 1: Priority 3** - Construction documentation does not match site conditions.

**ITEM 2: Priority 3** - Steel shed at roof and ground floor level with poor detailing.

**ITEM 3: Priority 3** - No waterproofing at roof level.

## Item 1 and actions

Construction documents do not match actual site conditions

**Priority 1  
(Immediate – Now)**

- None

**Priority 2  
(within 6 – weeks)**

- None

**Priority 3  
(within 6-months)**

- The Factory Engineer is to survey the actual site conditions and provide accurate as built drawings.

## Item 2 and actions

Steel shed at roof and ground floor levels with poor detailing.

### Priority 1 (Immediate – Now)

- None

### Priority 2 (within 6 – weeks)

- None

### Priority 3 (within 6-months)

- Produce an Engineering Assessment of the steelwork roofs.
- Improve with proper connections, fixing and bracing as necessary.

## Item 3 and actions

No waterproofing at roof level.

**Priority 1  
(Immediate – Now)**

- None

**Priority 2  
(within 6 – weeks)**

- None

**Priority 3  
(within 6-months)**

- Apply and maintain a new waterproofing membrane.